

BTS80



Floor Concealed Door Closers

BTS80 SERIES FLOOR-CONCEALED DOOR CLOSER

Dependable and Versatile Floor-Concealed Closer



The BTS80 Series of floor-concealed door closers offers adaptability to almost any installation.

The closer's compact body permits its use where a larger closer would be prohibitive. Versatility allows installation in thin slab concrete subfloor construction. A wide selection of

interchangeable spindles makes the BTS80 suitable for virtually any floor covering or threshold application. Because the BTS80 can control exceptionally heavy single- and double-acting doors, you can incorporate the floor closer into almost any design to meet most materials, size, and weight requirements.

Trouble-free performance under adverse climatic and traffic conditions makes the BTS80 floor-concealed closer dependable and a perfect choice for even the most rigorous applications. For total control and uncompromising creativity for any door opening, specify a BTS80 floor-concealed closer.

CONTENTS

BTS80 Series Floor-Concealed Closer	Overview	2
	Certification & Specifications	3
	How to Order	4
	Technical Details	5
	Applications	6
	Spindles	7

DORMA USA quality and environmental management systems in Reamstown, PA and Steeleville, IL are certified to ISO 9001:2008 and ISO 14001:2004.



Features	BTS80	BTS80	BTS80 F
ANSI Spring Size	3	4, 6	5
Non-handed unit suitable for both single- and double-acting doors	•	•	—
Controlled closing with two adjustable valves	175°–70° 70°–0°	175°–70° 70°–0°	180°–70° 7°–0°
Mechanical backcheck	—	•	•
Delayed Action	•	•	—
Multipoint hold open between 75° and 175°	•	•	—

• yes — no

SPECIFICATIONS

Certification

The DORMA BTS80 F Series is listed by U.L. and C.U.L. under their continuing reinspection programs.

The DORMA BTS80 Series is certified to the requirements of ANSI/BHMA A156.4 for grade 1 closers.

Specifications

All floor-concealed door closers shall be DORMA BTS80 Series employing a cam and roller mechanism. The closers shall be capable of controlling interior or exterior doors weighing up to 660 lb and measuring up to 4'-0" wide exterior and 4'-6" interior. The closers will have selectable multipoint hold open between approximately 75° and 175°. The closers will have

selectable delayed action to allow delayed closing from 175° to 75°. The closers will have mechanical backcheck at approximately 70°. Dual valve adjustment will provide controlled closing speed from approximately 175° opening range, even in cold temperature conditions. The closer will provide adjustment within the cement case to allow lateral and longitudinal adjustment of 1/4" and vertical height adjustment of 5/32". Field interchangeable spindles will be available to provide bottom door clearances ranging from 5/16" to 2-5/16".

Optional Specifications

The closers should be used with sealing compound SC2 to prevent water or cleaning solvent from entering the cement case.

Floor-concealed door closers for all fire doors shall be DORMA BTS80 F. The closers shall be single-acting and have controlled closing from a full 180°. A sweep range of 180°–0° and latch range of 7°–0° will help insure positive latching of the door.

Finishes

Optional Plated Finishes

- Brass: 605 (Bright) or 606 (Satin).
- Bronze: 611 (Bright), 612 (Satin), or 613 (Oxidized Satin Oil Rubbed).
- Nickel: 618 (Bright) or 619 (Satin).
- Chrome: 625 (Bright) or 626 (Satin).

Standard Sprayed Finishes

- Aluminum: 689.
- Bronze: 691 (Dull), 690 (Statuary), or 695 (Dark Duranodic).
- Gold: 696.
- Black: 693.

Optional DORMA Custom Color or Designer Color Finishes

Contact Customer Service.

Warranty

For details, refer to **DORMA Limited Warranty** on our website at go.dorma.com/terms.

Size Selection Chart BTS80 / BTS80 F

BTS80	BTS80 F	Exterior	Interior
ANSI Size 3		2'-6"–3'-0"	2'-6"–3'-6"
ANSI Size 4	ANSI Size 5	2'-6"–3'-6"	2'-6"–4'-0"
ANSI Size 6		3'-6"–4'-0"	4'-0"–4'-6"

Maximum door widths and recommended sizes shown are for average conditions. If there are unusual site conditions, e.g. high or exceptionally heavy doors or wind pressure, the next stronger spring size should be selected.

	A	B	C	D	E
Inches	1-13/32–1-21/32	2–2-1/4	2-3/8	3-1/8	13-7/16
Millimeters	36–42	51–57	60	78	341

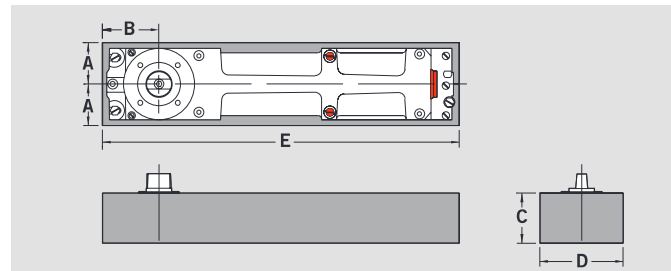

HOW TO ORDER BTS80 SERIES

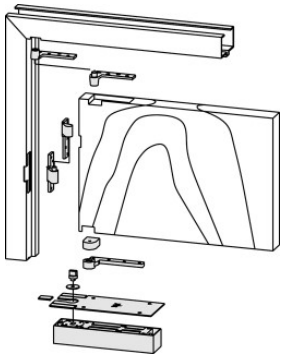

Spindle

1-1/2" Pre-Loaded Spindle	80030
1-5/16" Pre-Loaded Spindle	80025
1-1/8" Pre-Loaded Spindle	80020
7/8" Pre-Loaded Spindle	80015
3/4" Pre-Loaded Spindle	80010
1/2" Pre-Loaded Spindle	80005
5/16" Pre-Loaded Spindle	80003
2-5/16" Spindle	74050
2-1/16" Spindle	74045
1-7/8" Spindle	74040
1-11/16" Spindle	74035
1-1/2" Spindle	74030
1-5/16" Spindle	74025
1-1/8" Spindle	74020
7/8" Spindle	74015
13/16" Spindle	74012
3/4" Spindle	74010
5/8" Spindle	74007
1/2" Spindle	74005
5/16" Spindle	74003

Hand

Specify for Left Handed Units

LH

Specify for Right Handed Units

RH

Optional Accessories

E80624	Through Wire CH Top Pivot (4 wire)
E80622	Through Wire CH Top Pivot (2 wire)
HD8062	Heavy Duty CH Top Pivot
75200	Through Wire Intermediate Pivot for 3/4" Offset
15233	3 h Intermediate Pivot for 1-1/2" Offset
15222	20 min Intermediate Pivot for 1-1/2" Offset
15220	Through Wire Intermediate Pivot for 1-1/2" Offset
75243	3 h Intermediate Pivot for Lead Lined 3/4" Offset (see note*)
75242	20 min Intermediate Pivot for Lead Lined 3/4" Offset (see note*)
75240	Intermediate Pivot for Lead Lined 3/4" Offset (see note*)
75233	3 h Intermediate Pivot for 3/4" Offset
75222	20 min Intermediate Pivot for 3/4" Offset
75220	Intermediate Pivot for 3/4" Offset
SC2	Sealing Compound
TP80 CH	Terrazo Pan CH and 1-1/2" Offset
TP80	Terrazo Pan for 3/4" Offset

Deducts

LBX	Less Cement Box
LFP	Less Floor Plate
LTP	Less Top Pivot

BTS80	D		74010	RH	AMS		626	
CH Double Acting, Aluminum Door and Frame	A	3	Size 3, Light Opening Force, No Backcheck		AMS	All Metal Screws	600	Primed
CH Double Acting, Wood or Steel Door and Frame	B	4	Size 4, No Need to Specify		W2	All Wood Screws	689	Aluminum
1-1/2" Offset, Handed	C	5	Size 5, for use w/Fire Pkgs, No Delay, No Hold Open		W1	1/2 Wood Screws	690	Statuary Bronze
1-1/2" Offset, 20 min Rated Handed	C-E	6	Size 6, Strong		AMSAWS	All Metal Screws All Wood Screws	691	Dull Bronze
1-1/2" Offset, 3 h Rated Handed	C-F						693	Black
CH Single Acting, Aluminum Door and Frame	D	Spring Size			Fastener Packs		695	Dark Duranodic Bronze
CH Single Acting, Wood or Steel Door and Frame	E	3/4" Offset, Handed				Painted	696	Gold
Independent Hung, Non-Handed	F	3/4" Offset, 20 min Rated Handed					PNT	Special Sprayed Finish (must specify)
Independent Hung, Up to 3 h Rated, Non-Handed	G	3/4" Offset, 3 h Rated Handed				Bright Brass	605	
3/4" Offset Lead Lined, Handed*	H					Satin Brass	606	
3/4" Offset Lead Lined, 20 min Rated Handed*	I					Bright Bronze	611	
3/4" Offset Lead Lined, 3 h Rated Handed*	IF					Satin Bronze	612	
Independent Hung On Pocket Pivots, Non-Handed	L					Oxidized Satin Oil Rubbed	613	
	L-E					Bright Nickel	618	
	L-F					Satin Nickel	619	
	P					Bright Chrome	625	
	PF					Satin Chrome	626	

*** "L" Package Door Thickness Note:**
The standard door thickness is 1-3/4", and is the default unless otherwise specified.

Other alternative sizes are

Examples: L-E-2-1/2....75242-2-1/2

Example above 20 min. lead lined package for 2-1/2" thick door.

NOTE: All combinations of features and options are not available for all models.

TECHNICAL DETAILS

BTS80 Series

- Compact closer body and cement case 2-3/8" deep suited for thin slab concrete construction.
- Accommodates doors weighing up to 660 lb and 4'-6" wide interior and 4'-0" exterior.
- Closer adjustment in cement case provides lateral and longitudinal adjustment of 1/4" and height adjustment of 5/32".
- A pressure relief valve protects closer from damage caused by forced closing.
- Optional sealing compound SC2 prevents water or cleaning solvent from entering the cement case.
- **If door hardware or adjacent structures interfere with maximum opening, an auxiliary stop should be installed.**

BTS80

- Closer body is non-handed.
- Mechanical backcheck at approximately 70° (excluding size 3, where backcheck is removed to meet barrier-free through 90° of opening for easier passage).
- Selectable delayed action between 175° and 75°. Extends the closing cycle to allow unobstructed passage.
- Delayed action is functional when hold open is not engaged.
- Dual thermostatic control valves combined with special hydraulic fluid provide controlled closing from 175°.
- Selectable multipoint hold open between approximately 75° and 175°.
- Adjustment for start of hold open range or when delayed action releases. Adjustable between 75° and 105°.

- 1 Valve adjustment 70°–0°.
- 2 (a) Valve adjustment 175°–70°. (b) Selectable multipoint hold open between 75° and 175°. (c) Selectable delayed action from 175° to 75°.
- 3 Mechanical backcheck at approximately 70° (except size 3).
- 4 Start of hold open/end of delayed action range adjustment. Adjustable between 75° and 105°.

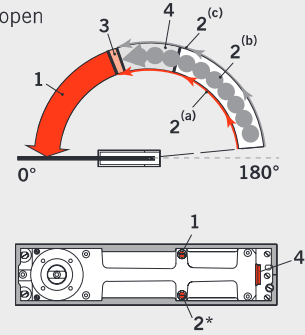

NOTE: Clockwise turns create a longer delay time with a slower closing speed. Turning valve completely clockwise creates hold open and eliminates delayed action.

BTS80 F

- U.L. listed for  use with fire doors.
- Closer body is handed.
- Non-hold open only.
- Mechanical backcheck at approximately 70°.
- Dual thermostatic control valves combined with special hydraulic fluid provide controlled closing from 180°.
- Recommended for applications using a wall magnet to hold a door open at 180°.

- 1 Valve adjustment 7°–0°.
- 2 Valve adjustment 180°–0°.
- 3 Mechanical backcheck at approximately 70°.

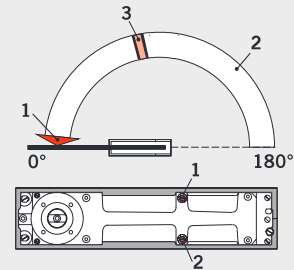

APPLICATIONS

Accessory packages for the following applications are designated with an alpha suffix— "A" or "B," for example.

For application details and accessory illustrations, see **BTS Applications and Accessories** brochure.

Center Hung Packages (A, B, G, H)

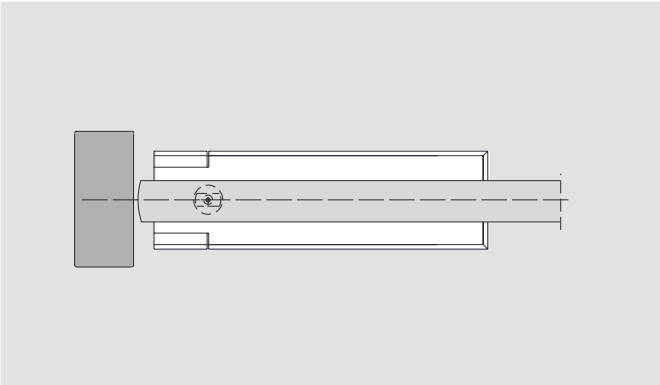

3/4" Offset Packages (D, E, F, L, L-E, L-F)

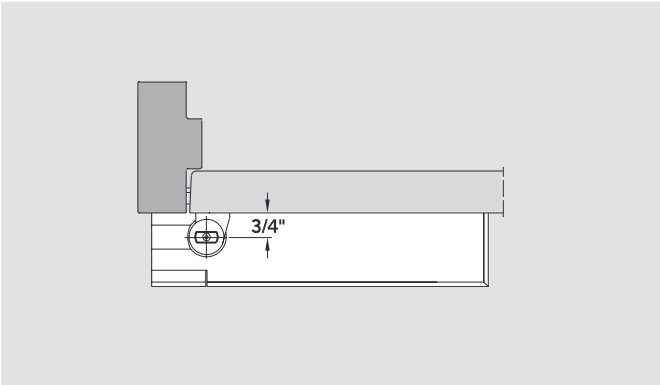

1-1/2" Offset Packages (C, C-E, C-F)

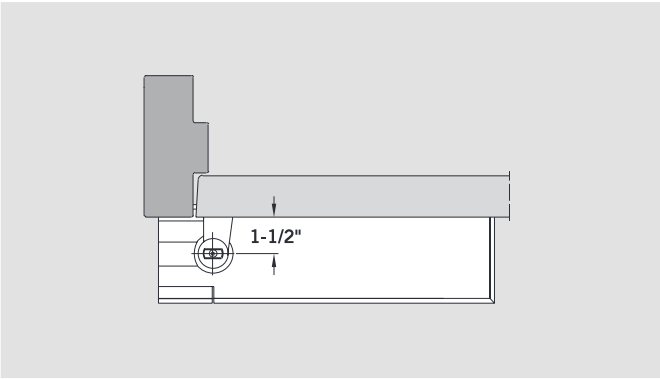

Pocket Door Packages (P) / Pocket Fire Door Packages (PF)

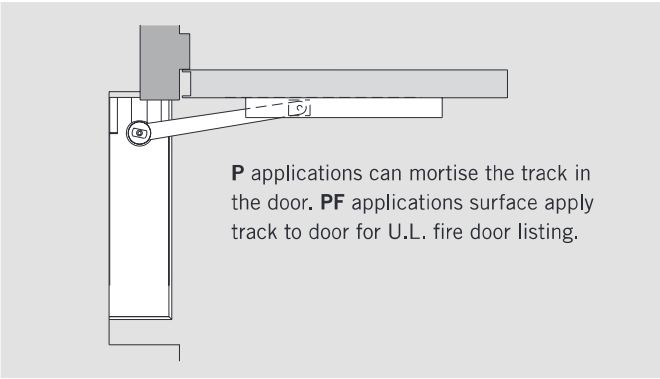

P applications can mortise the track in the door. **PF** applications surface apply track to door for U.L. fire door listing.

Independent Hung Door Packages (I)

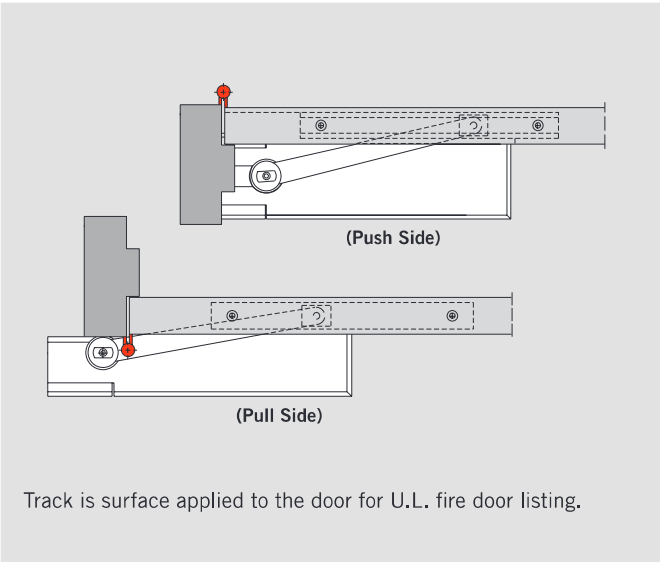

Track is surface applied to the door for U.L. fire door listing.

Independent Hung Fire Door Packages (IF)

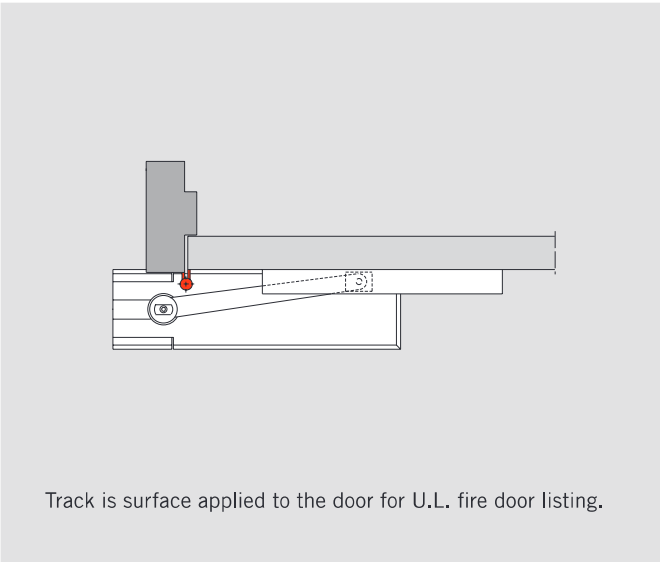

Track is surface applied to the door for U.L. fire door listing.

SPINDLES

Spindle #	Dimension "x" (Door Clearance)	3° Offset Spindle No.	Dimension "y"
74003	5/16"	80003	1/8"
74005	1/2"	80005	5/16"
74007	5/8"	—	7/16"
(STD) 74010	3/4"	80010	1/2"
74012	13/16"	—	5/8"
74015	7/8"	80015	11/16"
74020	1-1/8"	80020	7/8"
74025	1-5/16"	80025	1"
74030	1-1/2"	80030	1-5/16"
74035	1-11/16"	—	1-1/2"
74040	1-7/8"	—	1-11/16"
74045	2-1/16"	—	1-7/8"
74050	2-5/16"	—	2-1/16"

Offset Spindles

Spindles are available with a 3° offset for additional pressure to hold door in the closed position. Normally, this is only necessary for center-pivoted single acting applications. However, they can also be used with other applications to compensate for templating errors. Specify hand of offset spindle when ordering.

Center Hung Applications

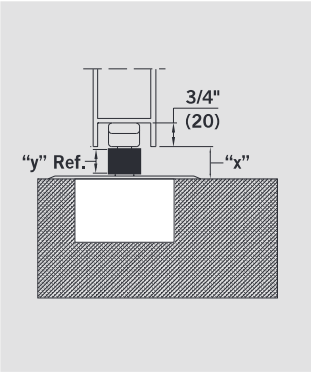

Offset Hung Applications

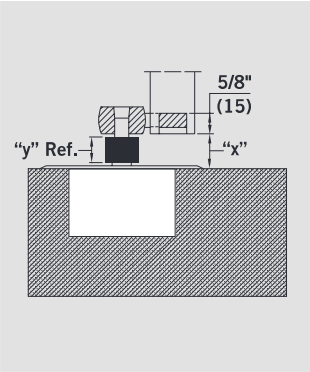

Extended Spindle Insert

NOTE: Closer and arm must be installed per template for door clearances shown to be valid.

Closers with extended spindle inserts are used with thresholds, carpeted floors, or terrazzo pans, or in cases where more clearance between door and floor is required. All spindles are zinc plated.

Cover Plate

Universal cover plate **7410**, suitable for left hand/right hand, 3/4" offset, 1-1/2" offset, and

center pivoted doors. Material is stainless steel or brass depending on the plated finish specified.

Center Pivoted Door

R.H. Offset Pivoted Door

L.H. Offset Pivoted Door

	G	H	I	J
Inches	4-1/8	14-3/32	2-9/32	3/32
Millimeters	105	358	58	2



www.dorma.com



DORMA USA, Inc.
Dorma Drive, Drawer AC
Reamstown, PA 17567
Tel: 800 523 8483
Fax: 800 274 9724
archdw@dorma-usa.com

DORMA Canada
1680 Courtney Park Drive, Unit 13
Mississauga, Ontario L5T 1R4
Tel: 800 387 4938
Fax: 905 670 5850
sales@dormacanada.com

DORMA Mexico
Calle Sur 110 no. 63, Col. Tolteca
01150 México, D.F.
Tel: 5255 5272 6937
Fax: 5255 5272 6948
operacion@dorma.com.mx

BTS

—

Applications & Accessories

ALUMINUM DOOR & FRAME CENTER HUNG—DOUBLE OR SINGLE ACTING

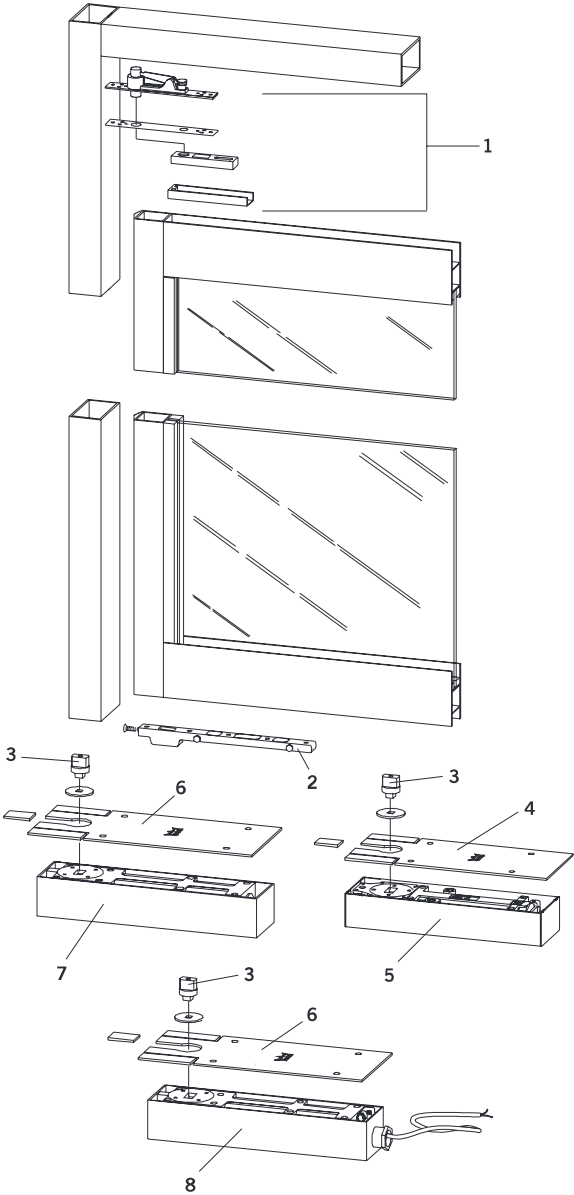

BTS 75V Packages		
Components	BTS 75V/A Center Hung, Double-Acting	BTS 75V/G Center Hung, Single-Acting
1. Top Pivot	8062	8062
2. Bottom Arm	7422	7422
3. Spindle	74010	80010
4. Cover Plate	7510	7510
5. Closer and Cement Case	BTS 75V	BTS 75V

BTS 80 Packages		
Components	BTS 80/A Center Hung, Double-Acting	BTS 80/G Center Hung, Single-Acting
1. Top Pivot	8062	8062
2. Bottom Arm	7422	7422
3. Spindle	74010	80010
6. Cover Plate	7410	7410
7. Closer and Cement Case	BTS 80	BTS 80

BTS 80 EMB Package	
Components	BTS 80 EMB/G Center Hung, Single-Acting
1. Top Pivot	8062
2. Bottom Arm	7422
3. Spindle	80010
6. Cover Plate	7410
8. Closer and Cement Case	BTS 80 EMB

Specify hand for G packages.

WOOD OR STEEL DOOR & FRAME
CENTER HUNG—DOUBLE OR SINGLE ACTING

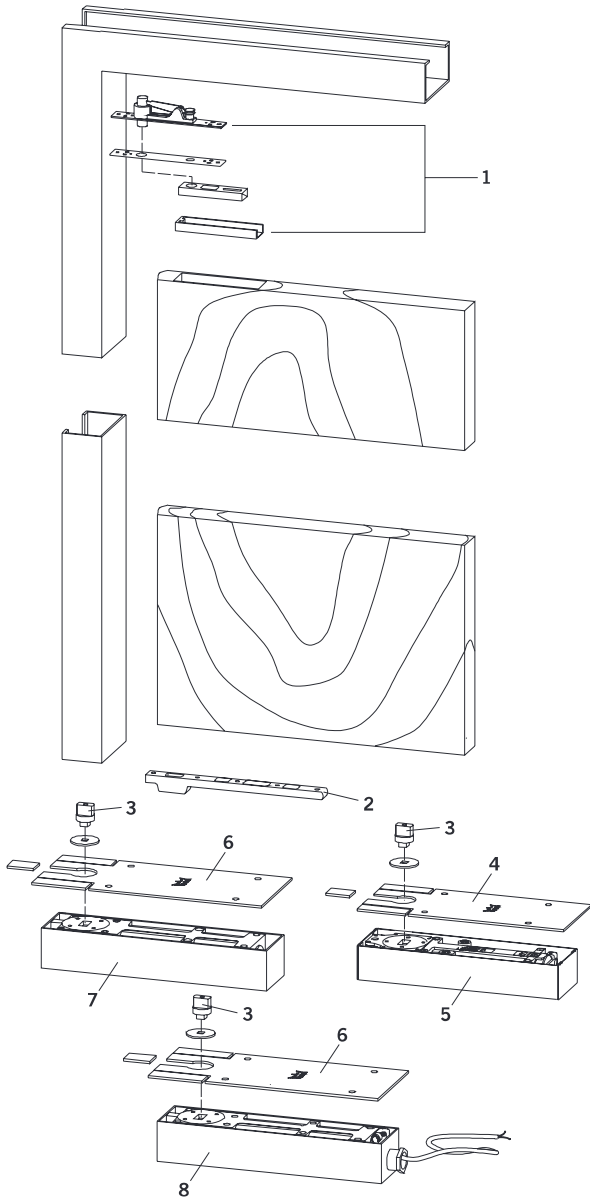

BTS 75V Packages

Components	BTS 75V/B Center Hung, Double-Acting	BTS 75V/H Center Hung, Single-Acting
1. Top Pivot	8062	8062
2. Bottom Arm	7421	7421
3. Spindle	74010	80010
4. Cover Plate	7510	7510
5. Closer and Cement Case	BTS 75V	BTS 75V

BTS 80 Packages

Components	BTS 80/B Center Hung, Double-Acting	BTS 80/H Center Hung, Single-Acting
1. Top Pivot	8062	8062
2. Bottom Arm	7421	7421
3. Spindle	74010	80010
6. Cover Plate	7410	7410
7. Closer and Cement Case	BTS 80	BTS 80

BTS 80 EMB Package

Components	BTS 80 EMB/H Center Hung, Single-Acting
1. Top Pivot	8062
2. Bottom Arm	7421
3. Spindle	80010
6. Cover Plate	7410
8. Closer and Cement Case	BTS 80 EMB

Specify hand for H packages.

3/4" OFFSET HUNG—SINGLE ACTING

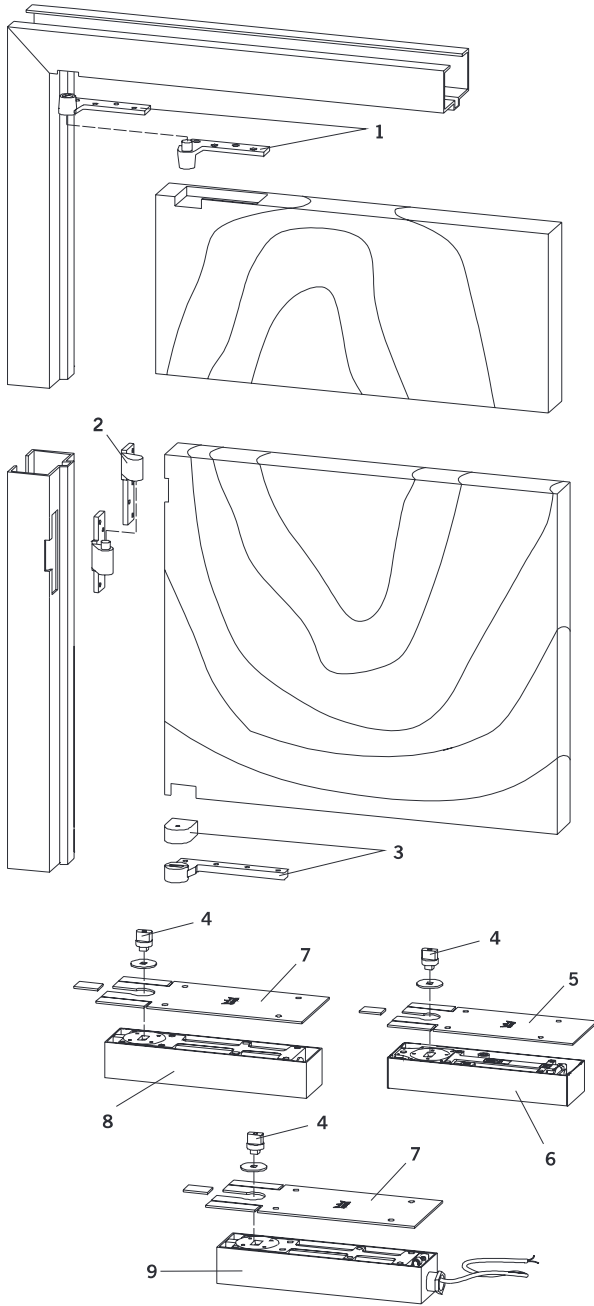

Specify hand for D, E, and F packages.

NOTE: NFPA 80 requires that labeled fire doors up to 60" in height be provided with 2 pivots and an additional pivot for each 30" of door height or fraction thereof. The same recommendation applies to non-labeled doors. Distance between pivots may exceed 30" on non-labeled doors.

BTS 75V Packages

Components	BTS 75V/D 3/4" Offset, Standard	BTS 75V/E 3/4" Offset, 20-Min Rated	BTS 75V/F 3/4" Offset, Up to 3-Hr Rated
1. Top Pivot	75120	75122	75133
2. Intermediate Pivot	75220 (optional)	75222 (required)	75233 (required)
3. Bottom Arm	75323	75323	75323
4. Spindle	74010	74010	74010
5. Cover Plate	7510	7510	7510
6. Closer and Cement Case	BTS 75V	BTS 75V NHO	BTS 75V NHO

BTS 80 Packages

Components	BTS 80/D 3/4" Offset, Standard	BTS 80/E 3/4" Offset, 20-Min Rated	BTS 80/F 3/4" Offset, Up to 3-Hr Rated
1. Top Pivot	75120	75122	75133
2. Intermediate Pivot	75220 (optional)	75222 (required)	75233 (required)
3. Bottom Arm	75323	75323	75323
4. Spindle	74010	74010	74010
7. Cover Plate	7410	7410	7410
8. Closer and Cement Case	BTS 80	BTS 80F NHO	BTS 80F NHO

BTS 80 EMB Packages

Components	BTS 80 EMB/D 3/4" Offset, Standard	BTS 80 EMB/E 3/4" Offset, 20-Min Rated	BTS 80 EMB/F 3/4" Offset, Up to 3-Hr Rated
1. Top Pivot	75120	75122	75133
2. Intermediate Pivot	75220 (optional)	75222 (required)	75233 (required)
3. Bottom Arm	75323	75323	75323
4. Spindle	74010	74010	74010
7. Cover Plate	7410	7410	7410
9. Closer and Cement Case	BTS 80 EMB	BTS 80 EMB	BTS 80 EMB

1-1/2" OFFSET HUNG—SINGLE ACTING

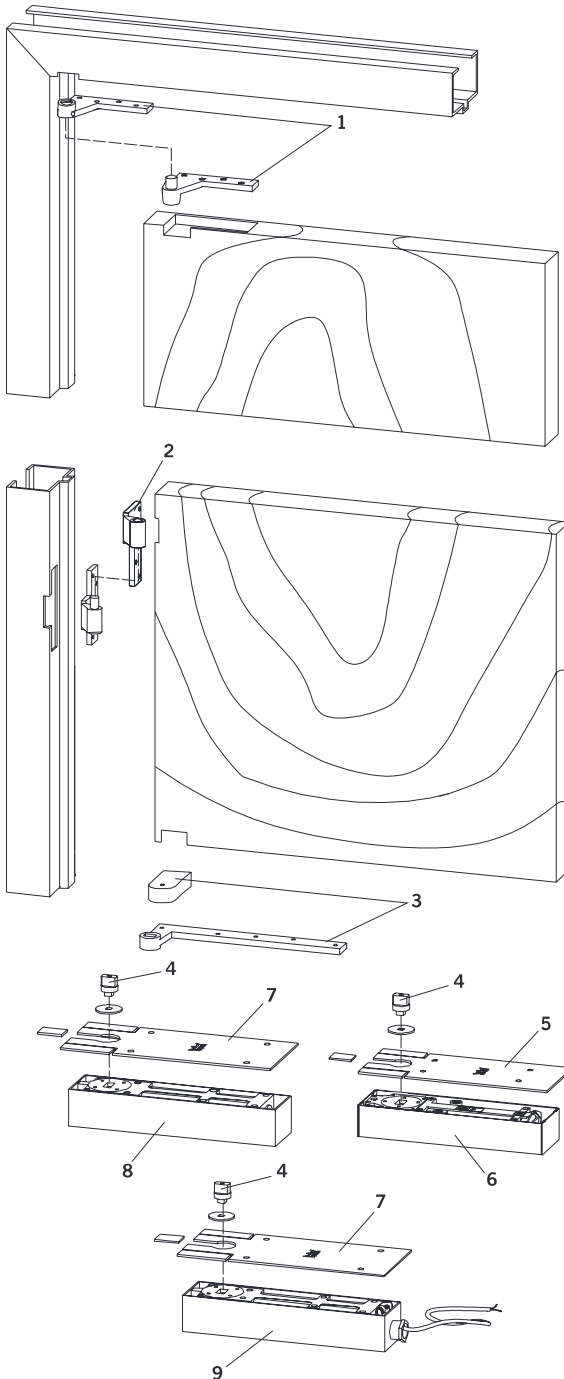

Specify hand for C, CE, and CF packages.

NOTE: It is recommended that doors up to 60" in height be provided with two pivots and an additional pivot for each 30" of door height or fraction thereof. Distance between pivots may exceed 30" on non-labeled doors.

BTS 75V Packages

Components	BTS 75V/C 1-1/2" Offset, Standard	BTS 75V/CE 1-1/2" Offset, 20-Min Rated	BTS 75V/CF 1-1/2" Offset, Up to 3-Hr Rated
1. Top Pivot	15120	15122	15133
2. Intermediate Pivot	15220 (optional)	15222 (required)	15233 (required)
3. Bottom Arm	15323	15323	15323
4. Spindle	74010	74010	74010
5. Cover Plate	7510	7510	7510
6. Closer and Cement Case	BTS 75V	BTS 75V NHO	BTS 75V NHO

BTS 80 Packages

Components	BTS 80/C 1-1/2" Offset, Standard	BTS 80/CE 1-1/2" Offset, 20-Min Rated	BTS 80/CF 1-1/2" Offset, Up to 3-Hr Rated
1. Top Pivot	15120	15122	15133
2. Intermediate Pivot	15220 (optional)	15222 (required)	15233 (required)
3. Bottom Arm	15323	15323	15323
4. Spindle	74010	74010	74010
7. Cover Plate	7410	7410	7410
8. Closer and Cement Case	BTS 80	BTS 80F NHO	BTS 80F NHO

BTS 80 EMB Packages

Components	BTS 80 EMB/C 1-1/2" Offset, Standard	BTS 80 EMB/CE 1-1/2" Offset, 20-Min Rated	BTS 80 EMB/CF 1-1/2" Offset, Up to 3-Hr Rated
1. Top Pivot	15120	15122	15133
2. Intermediate Pivot	15220 (optional)	15222 (required)	15233 (required)
3. Bottom Arm	15323	15323	15323
4. Spindle	74010	74010	74010
7. Cover Plate	7410	7410	7410
9. Closer and Cement Case	BTS 80 EMB	BTS 80 EMB	BTS 80 EMB

LEAD-LINED DOOR 3/4" OFFSET HUNG—SINGLE ACTING

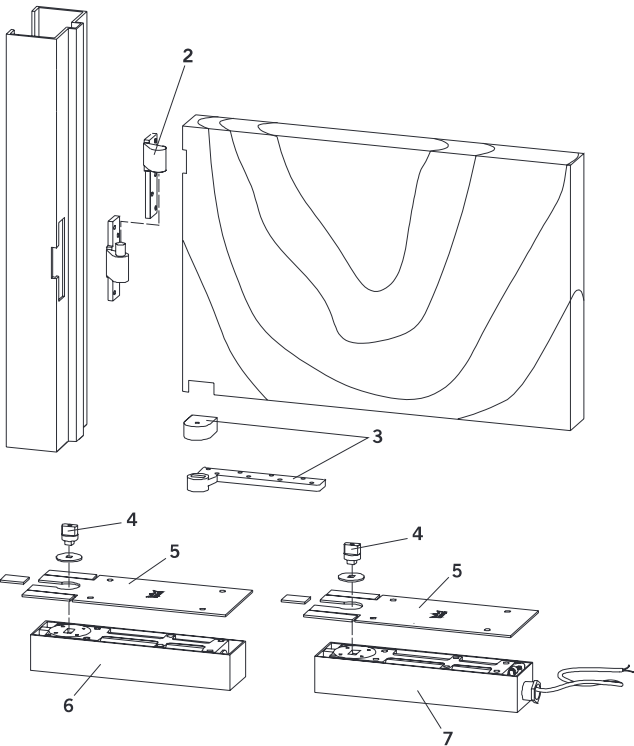
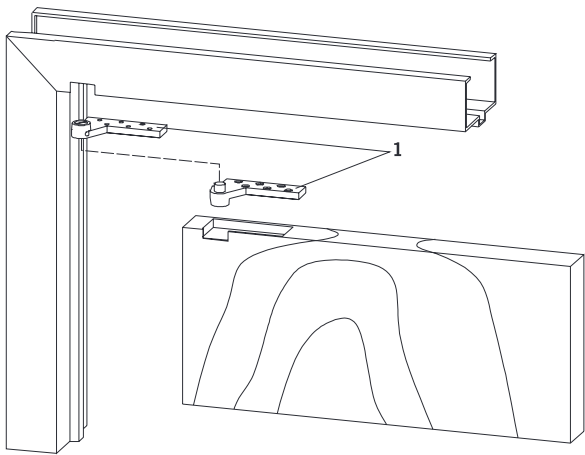

BTS 80 Packages

Components	BTS 80/L 3/4" Offset, Lead-Lined, Standard	BTS 80/LE 3/4" Offset, Lead-Lined, 20-Min Rated	BTS 80/LF 3/4" Offset, Lead-Lined, Up to 3-Hr Rated
1. Top Pivot	75140	75142	75143
2. Intermediate Pivot	75240 (optional)	75242 (required)	75243 (required)
3. Bottom Arm	75343	75343	75343
4. Spindle	74010	74010	74010
5. Cover Plate	7410	7410	7410
6. Closer and Cement Case	BTS 80	BTS 80F NHO	BTS 80F NHO

BTS 80 EMB Packages

Components	BTS 80 EMB/L 3/4" Offset, Lead-Lined, Standard	BTS 80 EMB/LE 3/4" Offset, Lead-Lined, 20-Min Rated	BTS 80 EMB/LF 3/4" Offset, Lead-Lined, Up to 3-Hr Rated
1. Top Pivot	75140	75142	75143
2. Intermediate Pivot	75240 (optional)	75242 (required)	75243 (required)
3. Bottom Arm	75343	75343	75343
4. Spindle	74010	74010	74010
5. Cover Plate	7410	7410	7410
7. Closer and Cement Case	BTS 80 EMB	BTS 80 EMB	BTS 80 EMB

Specify hand for L, LE, and LF packages.

NOTE: It is recommended that doors up to 60" in height shall be provided with two pivots and an additional pivot for each 30" of door height or fraction thereof. Distance between pivots may exceed 30" on non-labeled doors.

INDEPENDENTLY HUNG DOORS

Packages have been developed for use with 4-1/2" wide butt hinges. Applications using alternate hanging means should be submitted to DORMA's Technical Services Department for review and recommendation.

Hinges

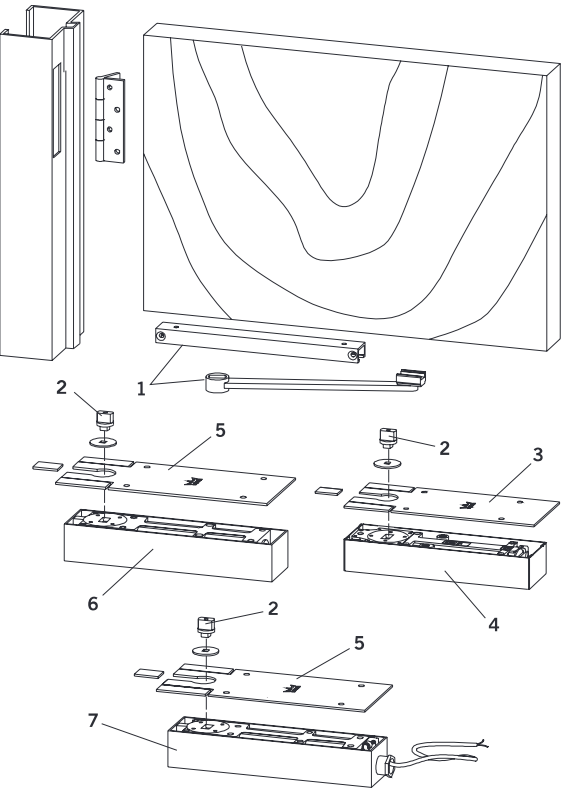

BTS 75V Packages		
Components	BTS 75V/I Standard	BTS 75V/IF 3-Hr Rated Steel, 1-1/2-Hr Rated Wood
1. Slide Arm Assembly	7451N	7451N
2. Spindle	74003	74003
3. Cover Plate	7510	7510
4. Closer and Cement Case	BTS 75V	BTS 75V NHO

BTS 80 Packages		
Components	BTS 80/I Standard	BTS 80/IF 3-Hr Rated Steel, 1-1/2-Hr Rated Wood
1. Slide Arm Assembly	7451N	7451N
2. Spindle	74003	74003
5. Cover Plate	7410	7410
6. Closer and Cement Case	BTS 80	BTS 80F NHO

BTS 80 EMB Packages		
Components	BTS 80 EMB/I Standard	BTS 80 EMB/IF 3-Hr Rated Steel, 1-1/2-Hr Rated Wood
1. Slide Arm Assembly	7451N	7451N
2. Spindle	74003	74003
5. Cover Plate	7410	7410
7. Closer and Cement Case	BTS 80 EMB	BTS 80 EMB

Specify hand for EMB/I and EMB/IF packages.

- I packages mortise the track in the bottom of the door.
- I packages can be installed on the push or pull side of an opening.
- IF packages surface apply the track to the face of the door.

INDEPENDENTLY HUNG DOORS

Packages have been developed for use with pocket pivots. Applications using alternate hanging means should be submitted to DORMA's Technical Services Department for review and recommendation.

Pocket Pivots

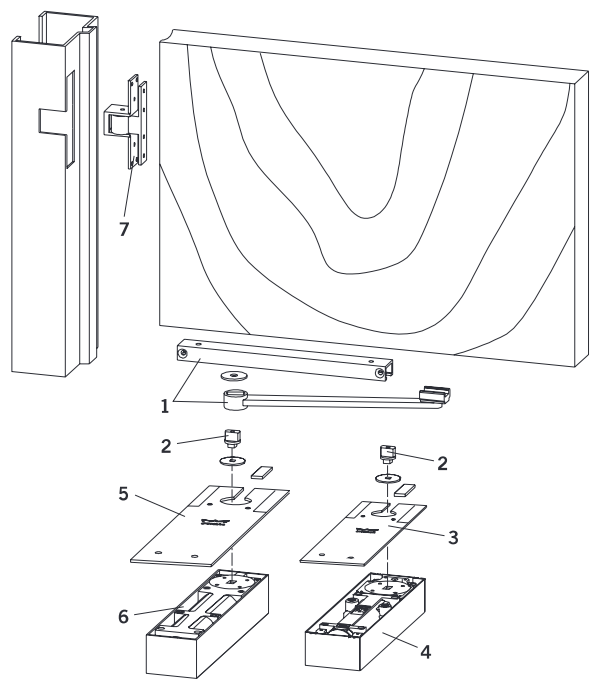

BTS 75V Packages

Components	BTS 75V/P Standard	BTS 75V/PF 3-Hr Rated Steel, 20-Min Rated Wood
1. Slide Arm Assembly	7451N	7451N
2. Spindle	74003	74003
3. Cover Plate	7510	7510
4. Closer and Cement Case	BTS 75V	BTS 75V NHO
7. Pocket Pivot	75520	75523

BTS 80 Packages

Components	BTS 80/P Standard	BTS 80/PF 3-Hr Rated Steel, 20-Min Rated Wood
1. Slide Arm Assembly	7451N	7451N
2. Spindle	74003	74003
5. Cover Plate	7410	7410
6. Closer and Cement Case	BTS 80	BTS 80F NHO
7. Pocket Pivot	75520	75523

Specify hand for P and PF packages.

- P packages mortise the track in the bottom of the door.
- PF packages surface apply the track to the face of the door.
- P and PF packages have three pocket pivots for doors up to 7'-6" tall. Taller doors should use an additional pivot for every 30" of door height or fraction thereof.

ACCESSORIES FOR CENTER HUNG INSTALLATIONS

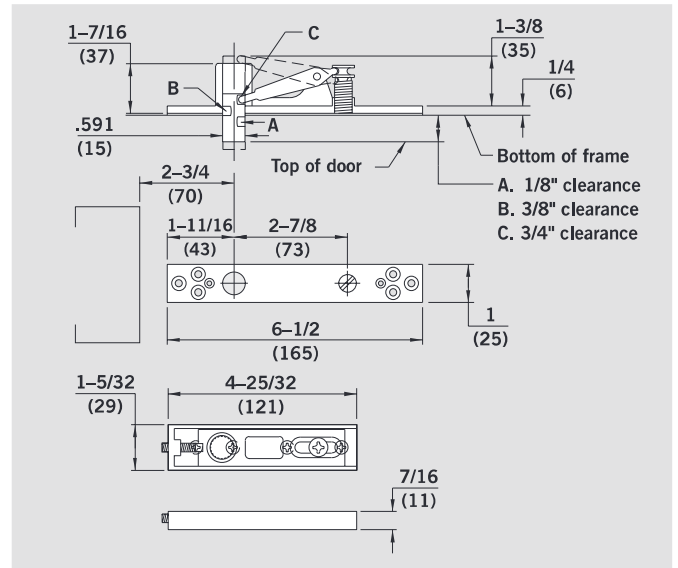
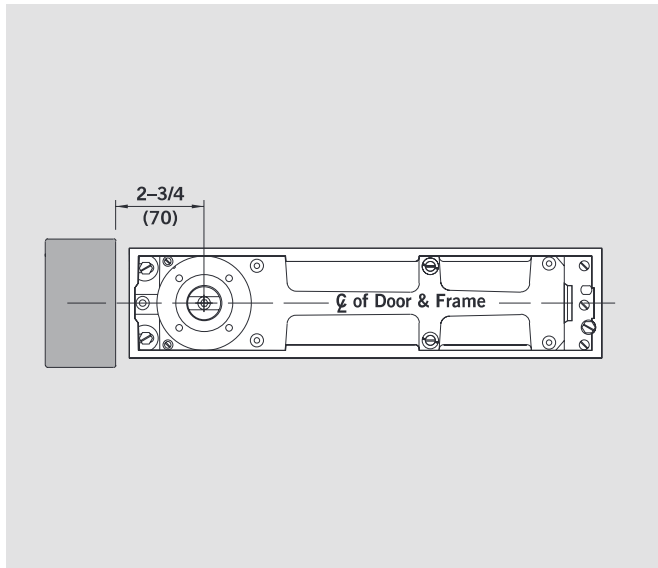

No. 8062 — Walking beam top pivot with cover plate.
Adjustable to obtain top door clearances of 1/8", 3/8" or 3/4".
Optional extended pin available for clearances of 3/4", 1" or 1-5/16".

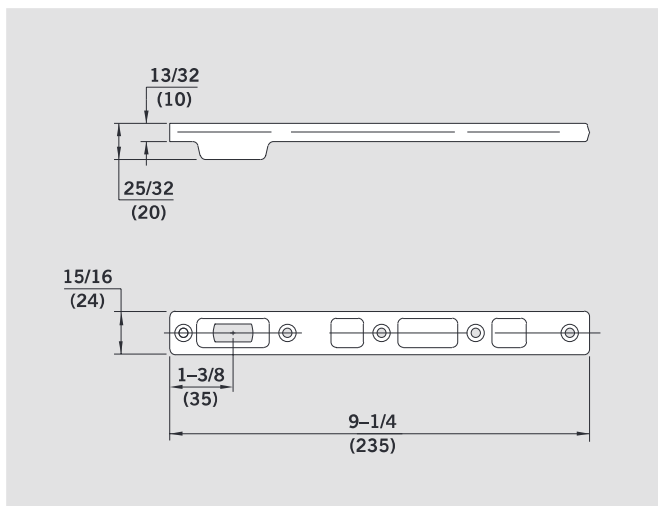

No. 7421 — Center hung bottom arm for steel or wood doors.

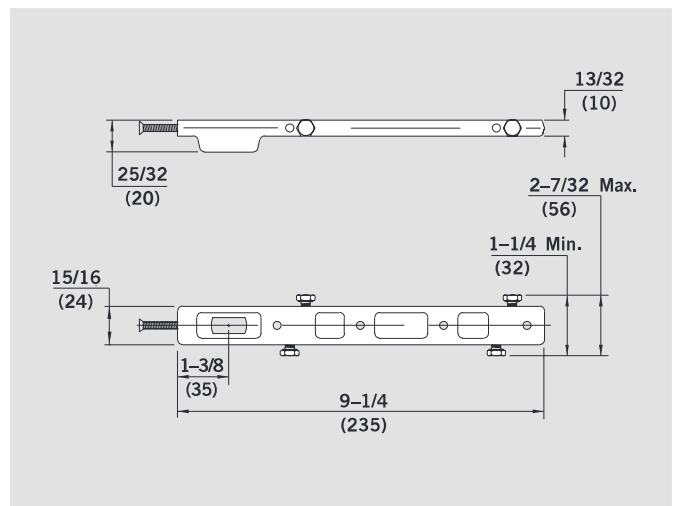

No. 7422 — Center hung bottom arm for aluminum doors.

ACCESSORIES FOR 3/4" OFFSET INSTALLATIONS

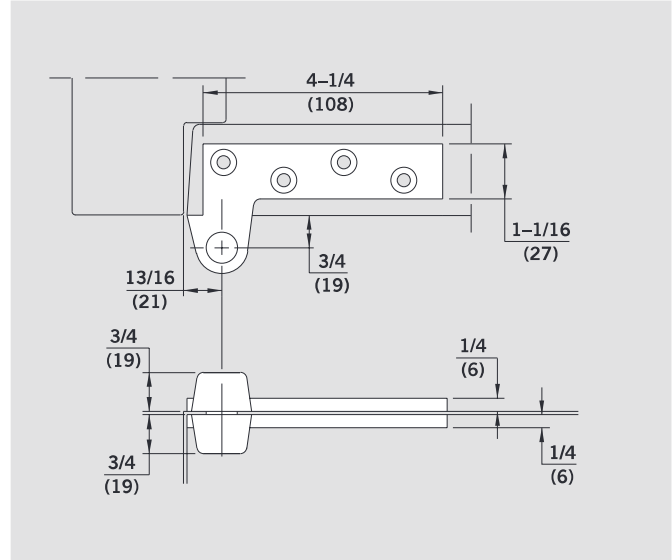
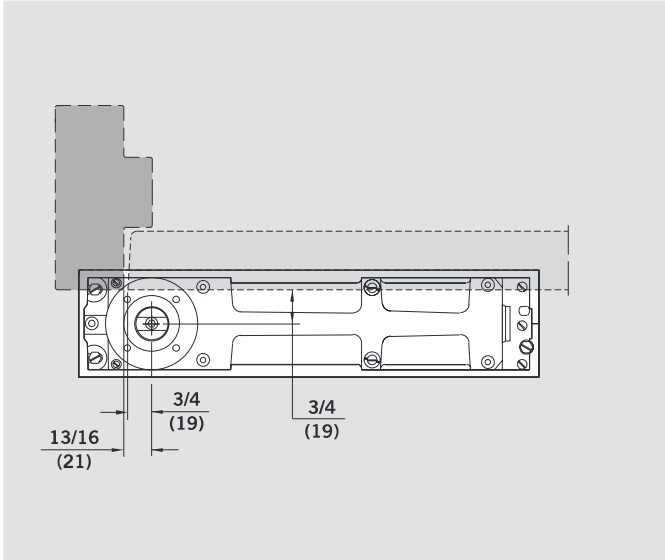

No. 75120 — 3/4" offset brass top pivot.

No. 75122 — 3/4" offset brass top pivot. U.L. listed for 20-minute rated fire doors.

No. 75133 — 3/4" offset steel top pivot. For use on fire doors rated up to three hours.

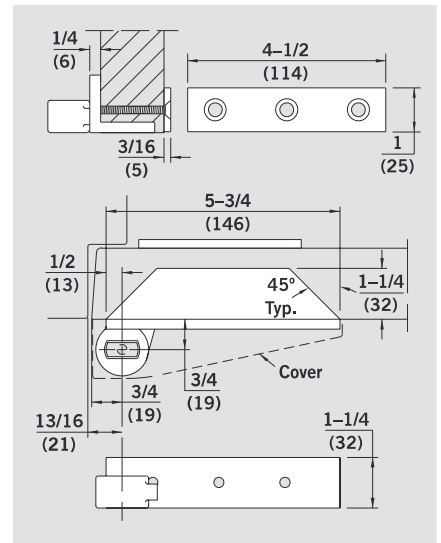
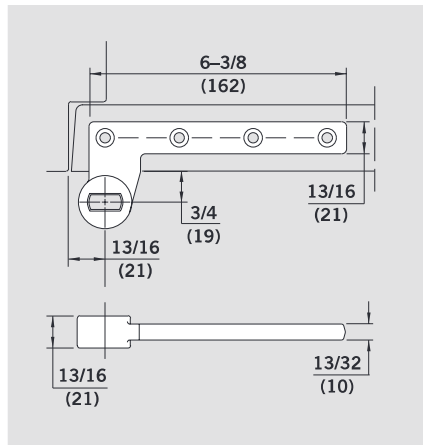
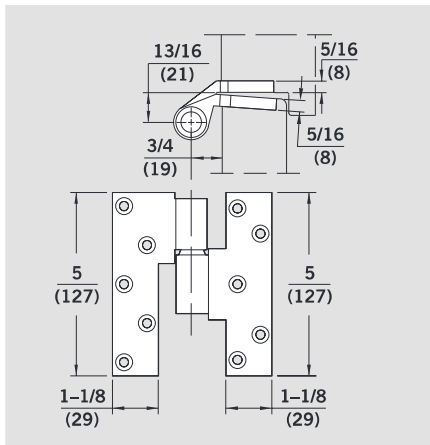

No. 75220 — 3/4" offset standard-duty brass intermediate pivot.

No. 75222 — 3/4" offset standard-duty brass intermediate pivot. U.L. listed for 20-minute rated fire doors.

No. 75233 — 3/4" offset heavy-duty steel intermediate pivot. For use on fire doors rated up to three hours.

(Specify Hand)

No. 75323 — 3/4" offset standard-duty steel bottom arm. Can also be used on fire doors rated up to three hours.

(Specify Hand)

No. 75353 — 3/4" offset steel bottom arm. Closer is removable without removing door. Intermediate pivots are required when using this arm.

(Specify Hand)

ACCESSORIES FOR 1-1/2" OFFSET INSTALLATIONS

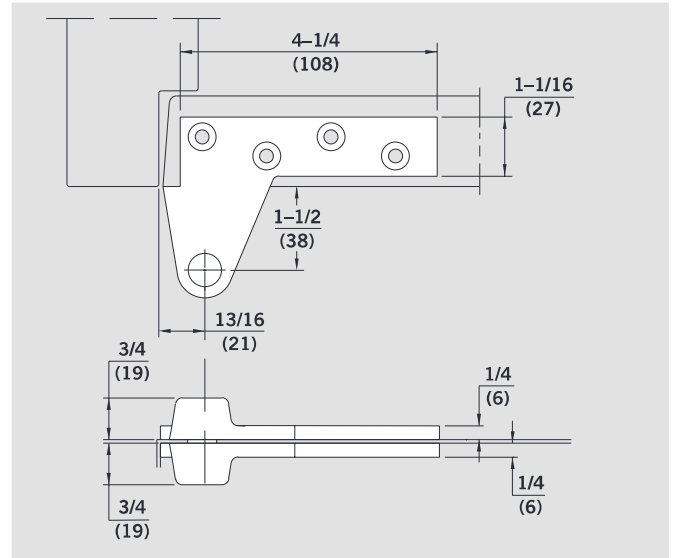
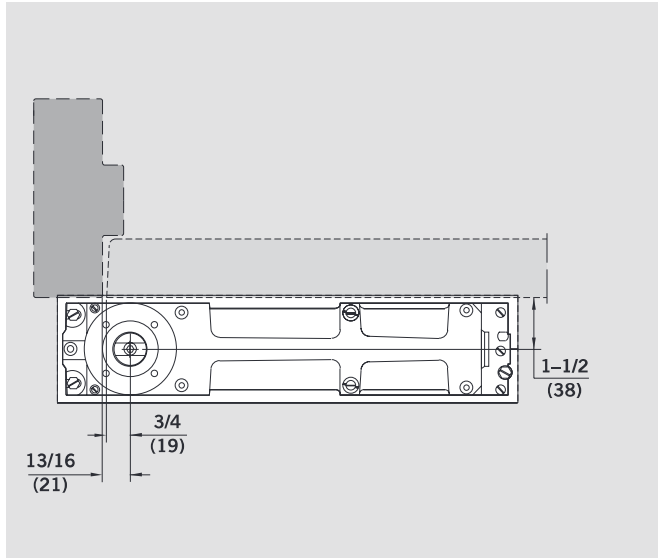

No. 15120 — 1-1/2" offset brass top pivot.

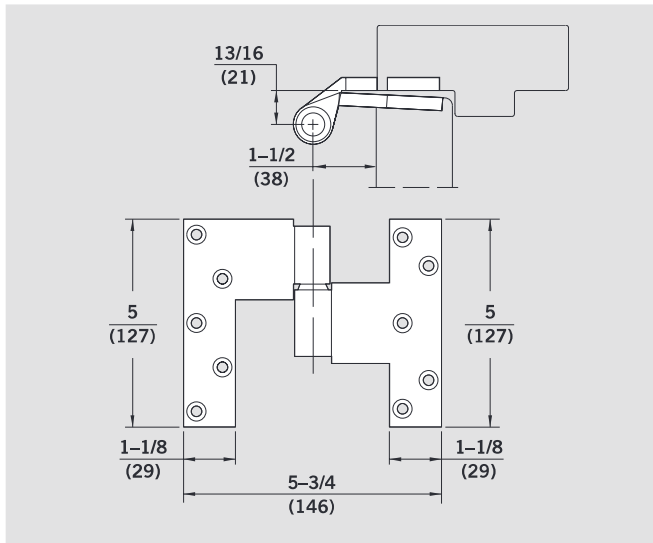

No. 15220 — 1-1/2" offset brass intermediate pivot.
(Specify Hand)

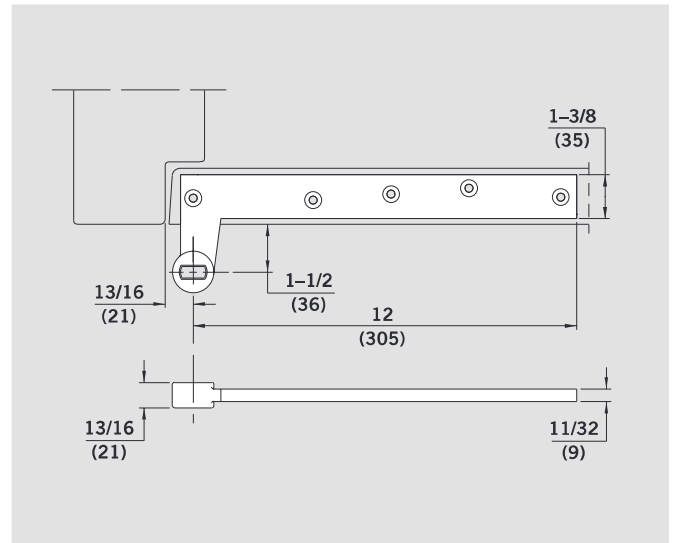

No. 15323 — 1-1/2" offset steel bottom arm.
(Specify Hand)

ACCESSORIES FOR 3/4" OFFSET LEAD-LINED INSTALLATIONS

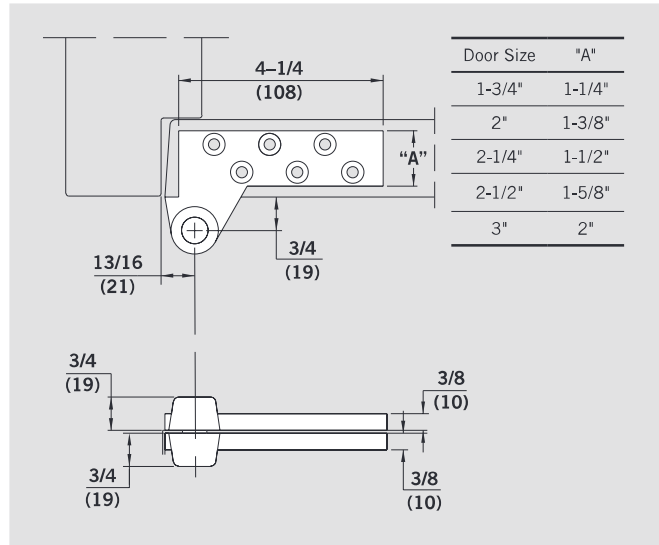
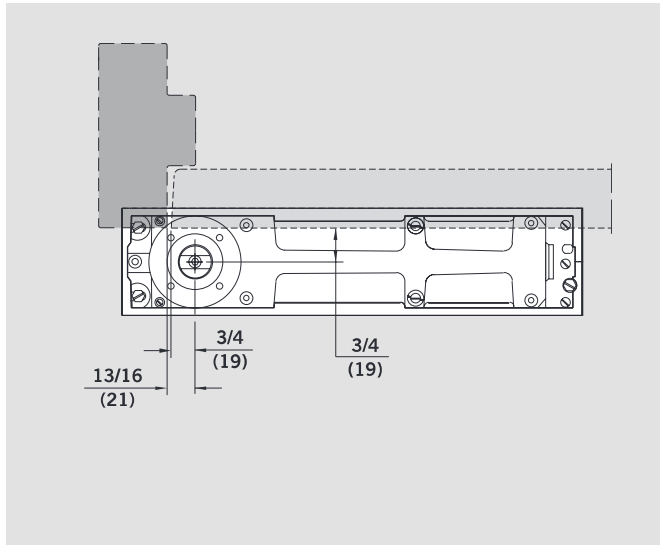

No. 75140 — 3/4" offset brass top pivot for lead-lined doors 1-3/4" thick.

Note: For doors 2" to 3" thick specify as follows:

No. 75140-2 — For use on doors 2" thick.

No. 75140-2-1/4 — For use on doors 2-1/4" thick.

No. 75140-2-1/2 — For use on doors 2-1/2" thick.

No. 75140-3 — For use on doors 3" thick.

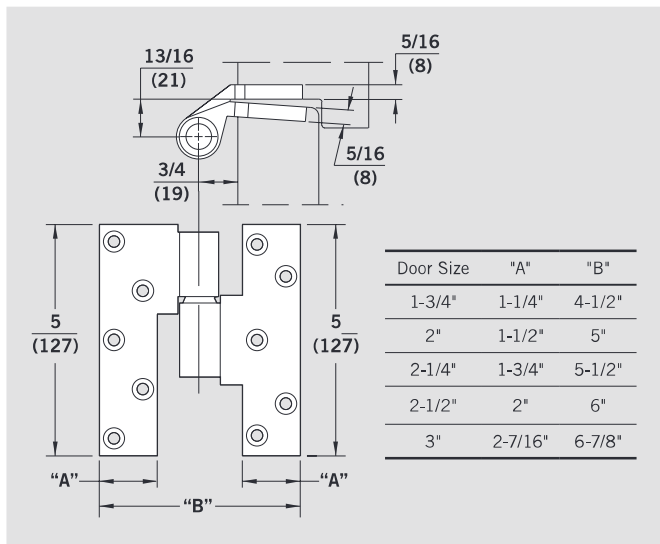

No. 75240 — 3/4" offset brass intermediate pivot for lead-lined doors 1-3/4" thick.

Note: For doors 2" to 3" thick specify as follows:

No. 75240-2 — For use on doors 2" thick.

No. 75240-2-1/4 — For use on doors 2-1/4" thick.

No. 75240-2-1/2 — For use on doors 2-1/2" thick.

No. 75240-3 — For use on doors 3" thick.

(Specify Hand)

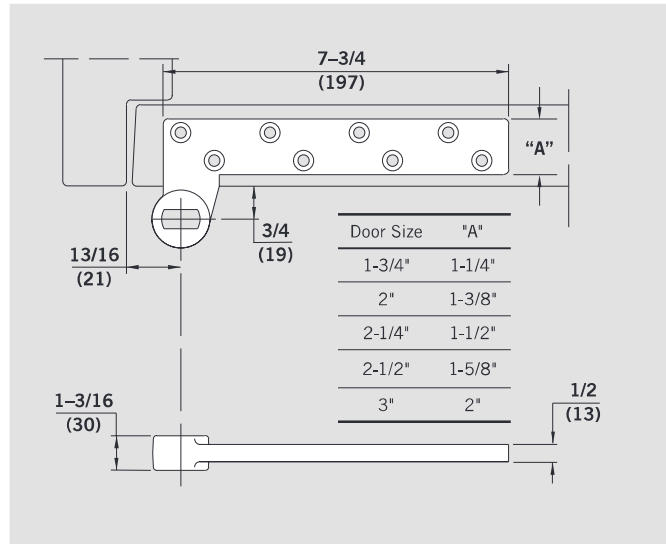

No. 75343 — 3/4" offset steel bottom arm for lead-lined 1-3/4" doors.

Note: For doors 2" to 3" thick specify as follows:

No. 75343-2 — For use on doors 2" thick.

No. 75343-2-1/4 — For use on doors 2-1/4" thick.

No. 75343-2-1/2 — For use on doors 2-1/2" thick.

No. 75343-3 — For use on doors 3" thick.

(Specify Hand)

ACCESSORIES FOR INDEPENDENTLY HUNG INSTALLATIONS

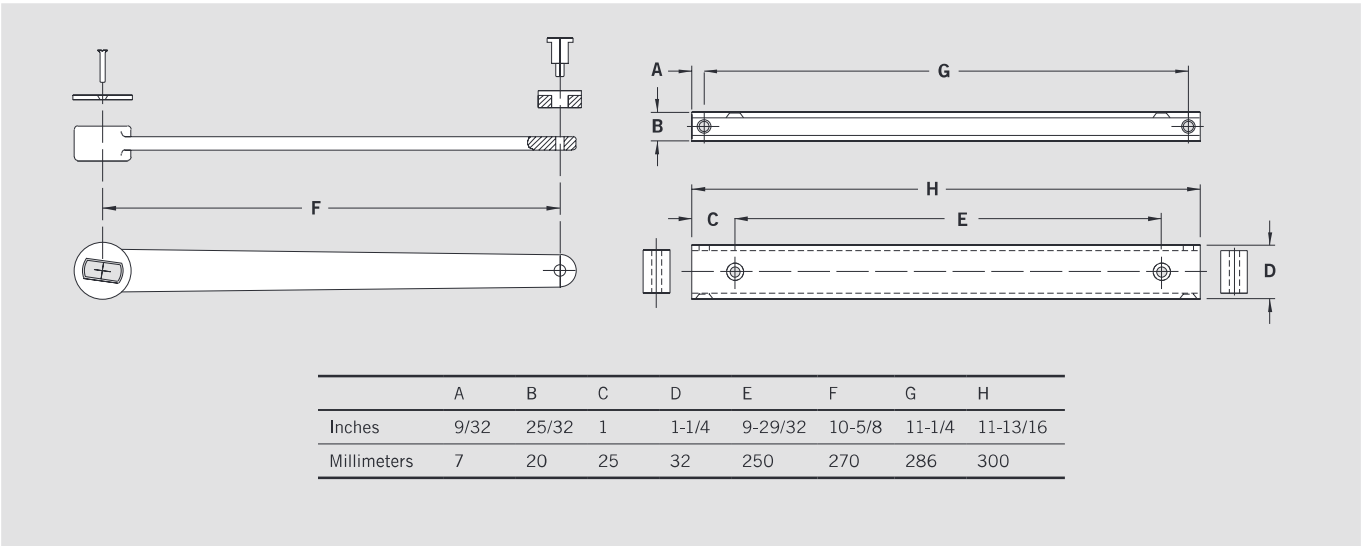

No. 7451N Slide Arm and Channel — Drop forged steel with nylon slide block, cover washer, and anodized aluminum channel.

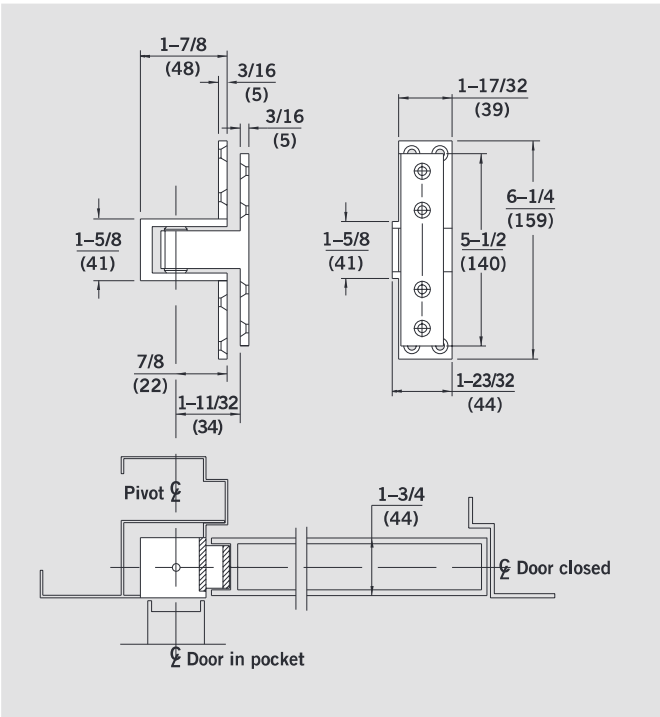

No. 75520 — Brass pocket pivot. For 90° pocket doors.

No. 75523 — Steel pocket pivot for 90° pocket doors.

U.L. listed for 20 minute wood doors and 3 hour rated steel fire doors.

(Specify Hand)

ACCESSORIES

Terrazzo Pan

BTS 75V Series

- TP 75V CH for center hung applications (shown).
- TP 75V RH or LH for 3/4" offset applications (specify hand).

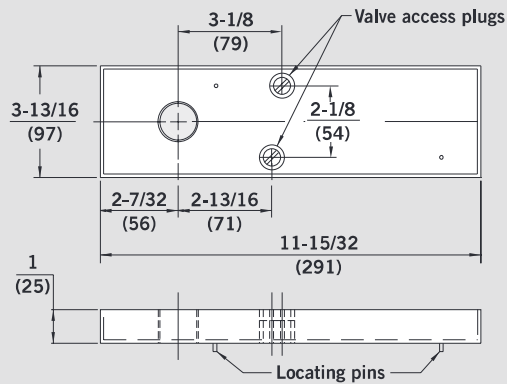

BTS 80/BTS 80 EMB Series

- TP 80 CH for center hung applications (shown).
- TP 80 RH or LH for 3/4" offset applications (specify hand).

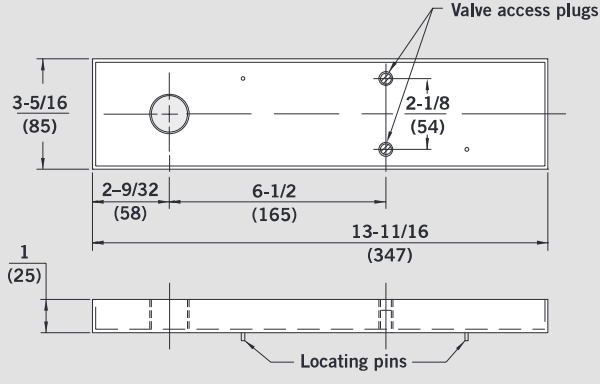

Made from stainless steel and used in lieu of standard floor plate. Offers uninterrupted appearance with terrazzo or marble. Shims are included to allow easy removal of pan after initial installation.

NOTE: When calculating the spindle size to be used with a terrazzo pan application, add 1" to the desired clearance between the door and the finished floor.

Cover Plate

The BTS 75V universal cover plate **7510**, suitable for left hand/right hand, 3/4" offset, 1-1/2" offset, and center pivoted doors.

	G	H	I	J
Inches	4-1/8	12-1/8	2-9/32	3/32
Millimeters	105	308	58	2

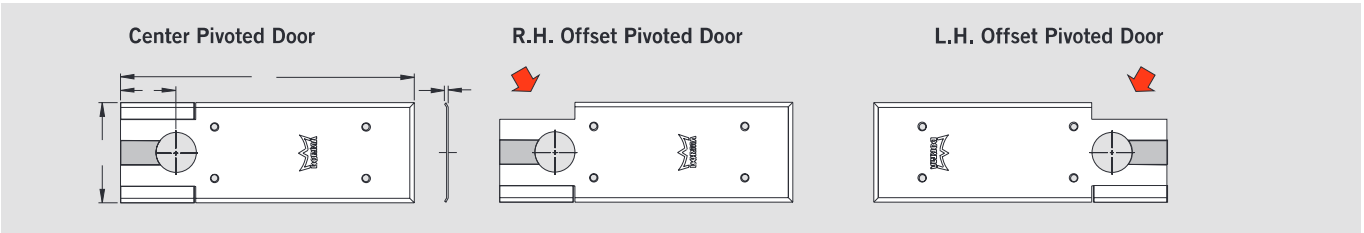

The BTS 80 and BTS 80 EMB universal cover plate **7410**, suitable for left hand/right hand, 3/4" offset, 1-1/2" offset, and center pivoted doors.

	G	H	I	J
Inches	4-1/8	14-3/32	2-9/32	3/32
Millimeters	105	358	58	2

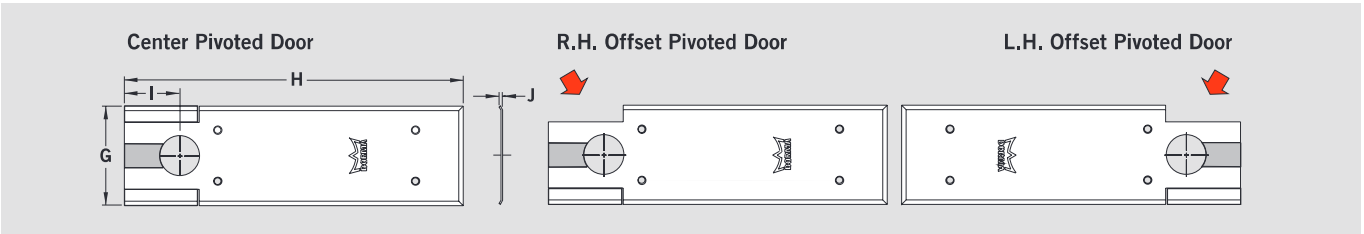

Spindles

Spindle No.	Dimension "x" (Door Clearance)	3" Pre-load Spindle No.	Dimension "y"
74003	5/16"	80003	1/8"
74005	1/2"	80005	5/16"
74007	5/8"	-	7/16"
74010 ((STD))	3/4"	80010	1/2"
74012	13/16"	-	5/8"
74015	7/8"	80015	11/16"
74020	1-1/8"	80020	7/8"
74025	1-5/16"	80025	1"
74030	1-1/2"	80030	1-5/16"
74035	1-11/16"	-	1-1/2"
74040	1-7/8"	-	1-11/16"
74045	2-1/16"	-	1-7/8"
74050	2-5/16"	-	2-1/16"

Extended Spindle Insert

NOTE: Closer and arm must be installed per template for door clearances shown to be valid.

Closers with extended spindle inserts are used with thresholds, carpeted floors, terrazzo pans or in cases where more clearance between door and floor is required. All spindles are zinc plated.

Center Hung Applications

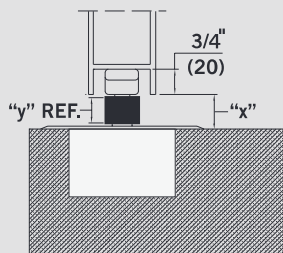

Offset Hung Applications

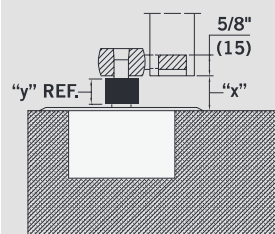

Pre-load Spindles

Spindles are available with a 3° pre-load for additional pressure to hold door in the closed position. Normally, this is only necessary for center-pivoted single acting applications. However, they can also be used with other applications to compensate for templating errors. Specify hand of pre-load spindle when ordering.



www.dorma.com



DORMA USA, Inc.
Dorma Drive, Drawer AC
Reamstown, PA 17567
Tel: 800 523 8483
Fax: 800 274 9724
archdw@dorma-usa.com

DORMA Canada
1680 Courtney Park Drive, Unit 13
Mississauga, Ontario L5T 1R4
Tel: 800 387 4938
Fax: 905 670 5850
sales@dormacanada.com

DORMA Mexico
Calle Sur 110 no. 63, Col. Tolteca
01150 México, D.F.
Tel: 5255 5272 6937
Fax: 5255 5272 6948
operacion@dorma.com.mx